

U-405 SUPERFICIES

M2 INTERIORES : 69.17 M2

M2 EXTERIORES : 9.15 M2

M2 TOTALES : 78.32 M2

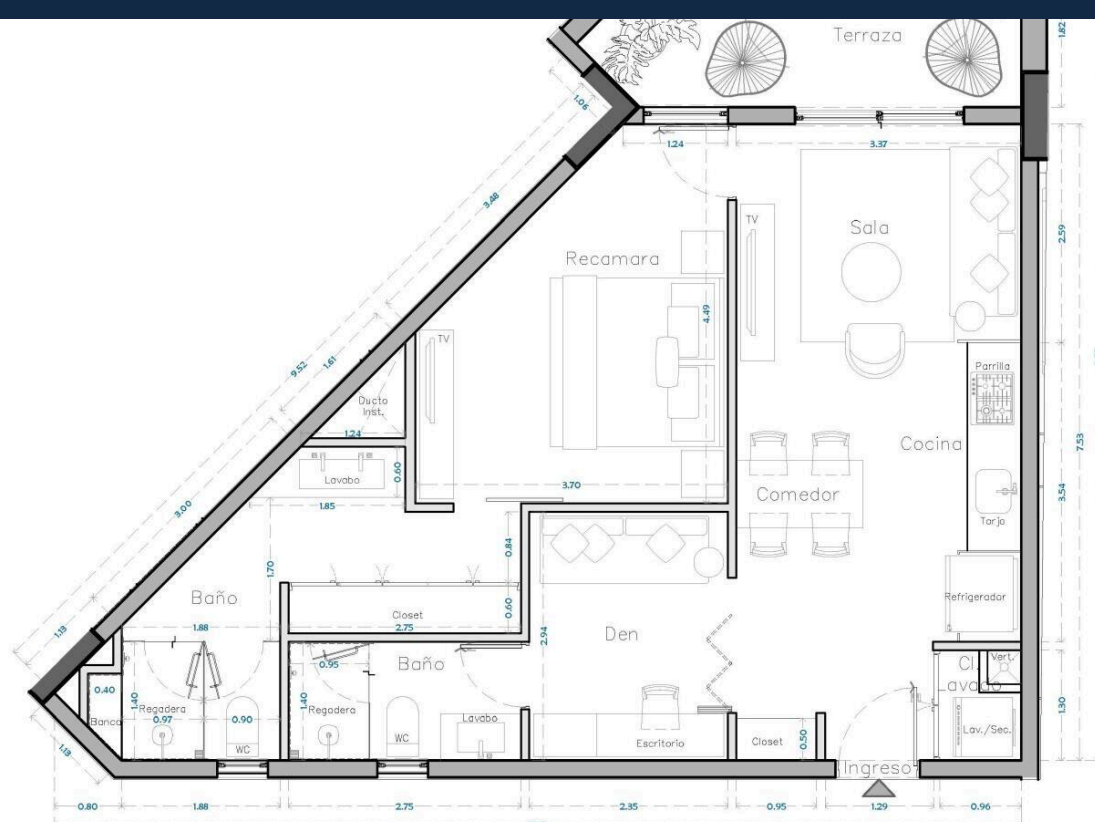

FACHADA NORTE (OCEANO)



FACHADA DESDE CARRETERA



ESCALA:

South Bay 405

\$561,119.00 USD

South Bay | 65 # Units in Develop | Emiliano Zapata
Centro South, Puerto Vallarta
MLS ID: 39724

General Information

Total m2:	78	Total M2 const:	78.32
Total SqFt:	842.72	Walls:	Concrete
Price/Sq Meter:	7,164.44	Total Bedrooms:	1
Total Baths:	2	Full baths:	2
Floor Number:	Nivel 04	Primary View:	Ocean
Secondary View:	Mountain	Furnished:	Unfurnished
Pet Friendly:	Yes	Parking:	Parking on Property
Location:	City		

Features & Amenities

Common Amenities

24 Hours Security:		Elevator:	
Fire Pit:		Garden:	
Gym:		Intercom:	
Jacuzzi:		Pool:	
Appliances			
Hood/Vent:		Refrigerator/Freezer:	
Oven:	Electric	Cook Top:	Electric
Devices			
Water Heater:	Electric		

Hoa Info

Hoa Name:		Dues per month (\$MX):	8,341.00
24-hr Security:		Building Insurance:	
Common Area Electric:		Common Area Maintenance:	
Garden Maintenance:		Gym:	
On-Site Admin:		Pool Maintenance:	

Especifications

Days On Market	304	Pre-Construction	Yes
Est. Delivery Date	2027-02-10	Title	Escritura, Fideicomiso
Electricity	CFE	Water	City
Sewage	City	Road Type	Paved